

Verb.:

REGIONE BASILICATA
COMUNE DI TITO

PROGETTO PLANIVOLUMETRICO DEL
 SUB DISTRETTO URBANO
 " DUP C1.5 "



IN C/DA MACCHIA DI TITTO SCALO

ELABORATI: PLANIMETRIA ACQUE BIANCHE - FOGNA E ALLACCI





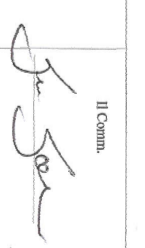

ALLEGATO N°: A TAV. N°: II SCALA URBANO: 1:500 DATA: aprile 2018

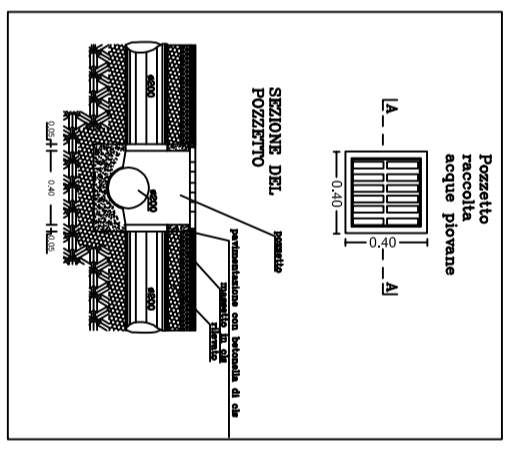
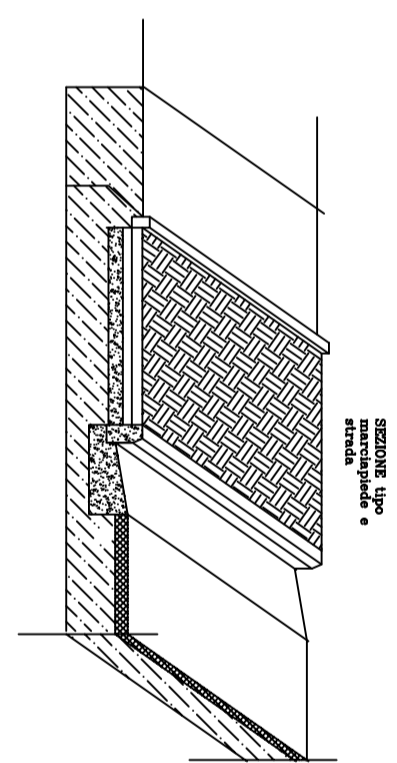
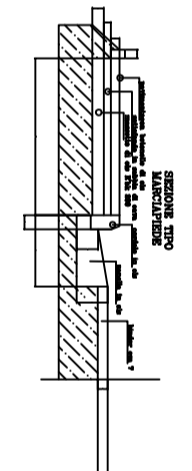
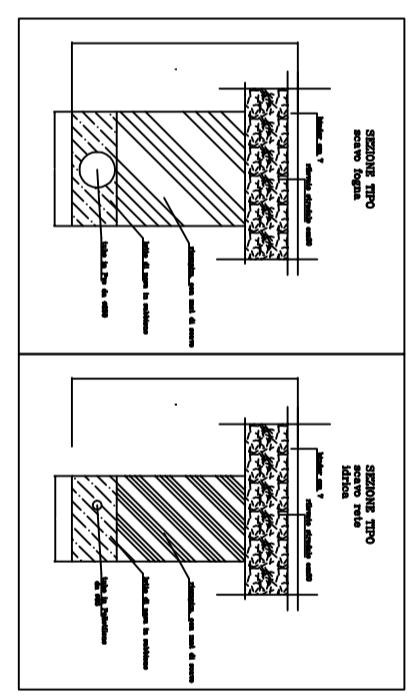
COMITENTE: SAMMAR srl.

Pro. Trans. N°:

Il Comm. 



- legenda**
-  pozzetto sifonato allaccio fogna
 -  pozzetto scarico fogna ispezionabile 1.00x1.00 mt
 -  Tubi in PVC UNI 7443/85 Tipo 303-2-Ø 250 condotte fogna-acque bianche
 -  pozzetti con caditoia in ghisa sferoidale 40x40
 -  Tubo in PVC Ø 160 allaccio caditoia
 -  Allaccio rete idrica
 -  Rete idrica principale Ø 100 in acciaio

